



Interspan All-Metal Series FS 146

For floors with large movements - all metal profile to be used by private cars and pedestrians

Joint Width:
114 mm maximum

Movement Capacity:
up to ± 25 mm

Features

Resistant to floor wash-down fluids

- Solid metal - profile hard wearing and long lasting

- Good skid resistance given by striated surface

- Visible surface shows no gap to avoid dirt accumulation

- Profile absorbs movement in three directions

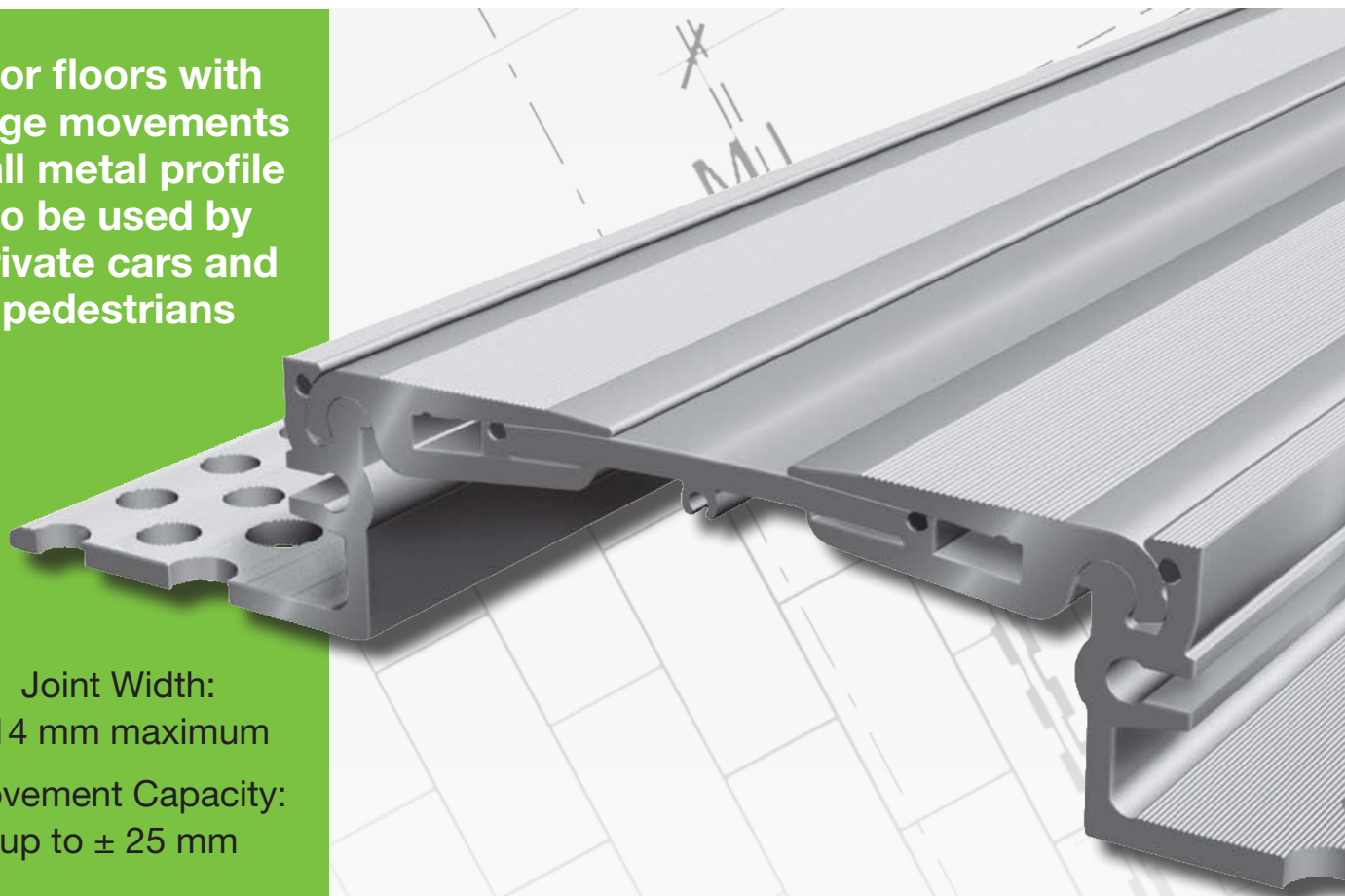

Profile	Joint width max. mm	Total movement mm	Visible width of profile mm	Total width of profile mm	Installation height mm	Load capacity privat cars kN
FS 146/2200	114	50 \pm 25	146	262	22	12
FS 146/3000	114	50 \pm 25	146	262	30	12
FS 146/4200	114	50 \pm 25	146	266	42	12
FS 146/5200	114	50 \pm 25	146	266	52	12
FS 146/6200	114	50 \pm 25	146	266	62	12
FS 146/7700	114	50 \pm 25	146	268	77	12
FS 146/8700	114	50 \pm 25	146	268	87	12
FS 146/9700	114	50 \pm 25	146	268	97	12

When specifying joint - please use full profile reference

compriband

Interspan All-Metal Series FS 146

Product Information

Material

Cold drawn Aluminium with rubber cord seals

Typical Uses

Pedestrian areas

Profile Lengths

Standard profile length = 4 metres
Shorter lengths are available on request

Profile Options

- Standard or staggered legs
- E3 & E4 side fix versions
- FSN top fix version
- Combinations of the above

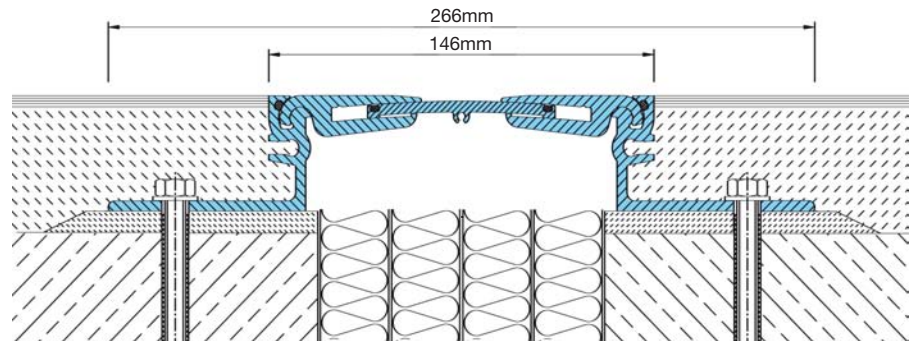

FS 146/4200

General Information

Fixings

Bedded and levelled on a 10mm epoxy mortar bed, mechanically fixed at 300mm symmetrical centres using FX01 fixing (chemical anchor) or M10 Multi Monti type fixing (concrete self tapping type bolt).

Additional sealant

A soft joint between the floor finish and the joint profile may be required to accommodate any local movement between the two. A suitable sealant for this would be Tremco Dymonic NT applied in a 6mm gap (max).

Maintenance

Periodic visual inspections should be carried out to ensure that no damage has occurred to the joints. Cleaning should be carried out using a mild detergent and water. If alternative cleaning chemicals or equipment are to be used, it is recommended that a suitability test should be carried out on a small section of the product in a non-prominent section of the joint.

For further advice or assistance, please contact Tremco illbruck on:

0191 419 0505

Whilst every care has been taken in the preparation of this information, no warranty is given or implied in connection with any recommendation or suggestion made herein or by our Representatives, Agents or Distributors. We reserve the right to modify specifications from time to time without prior notice. Users are advised to conduct their own tests in order to determine the suitability of the product for the intended purpose. All goods are supplied subject to standard Conditions of Sale which are available upon request.